

## 4 Lyndhurst Drive Harpenden, AL5 5QN

An attractive and popular style of home located in one of Harpenden's most sought after central locations within walking distance of the station, town centre and excellent junior and secondary schools. The property occupies a superb plot and offers a tremendous amount of potential for a large rear extension (STPP).

**Guide price £2,000,000**

# 4 Lyndhurst Drive

Harpenden, AL5 5QN



- Attractive Jarvis built home with immense potential (STPP)
- Ground floor Shower Room
- Close to excellent junior and secondary schools
- Prime central location
- Garage and 2 driveways
- Walking distance of the station & town centre
- Excellent Home office
- Mature 100ft south west facing garden
- Council Tax Band G

## Entrance Hall

## Wet Room

## Kitchen/Breakfast Room

18'11" x 11'6" (5.78m x 3.52m)

## Boot Room

## Dining Room

17'0" x 12'10" (5.19m x 3.93m)

## Living Room

18'11" x 12'11" (5.78m x 3.96m)

## Bedroom One

18'11" x 10'7" (5.78m x 3.23m)

## Bedroom Two

11'6" x 9'2" (3.52m x 2.80m)

## En-suite Shower room

## Bedroom Three

9'10", 203'4" x 11'4" (3.62m x 3.46m)

## Bedroom Four

12'10" x 6'11" (3.93m x 2.13m)

## Bathroom

## Home Office

16'2" x 8'3" (4.94m x 2.54m)

## Detached Garage

14'8" x 8'2" (4.49m x 2.49m)

## Covered Area

11'8" x 6'9" (3.56m x 2.06m)

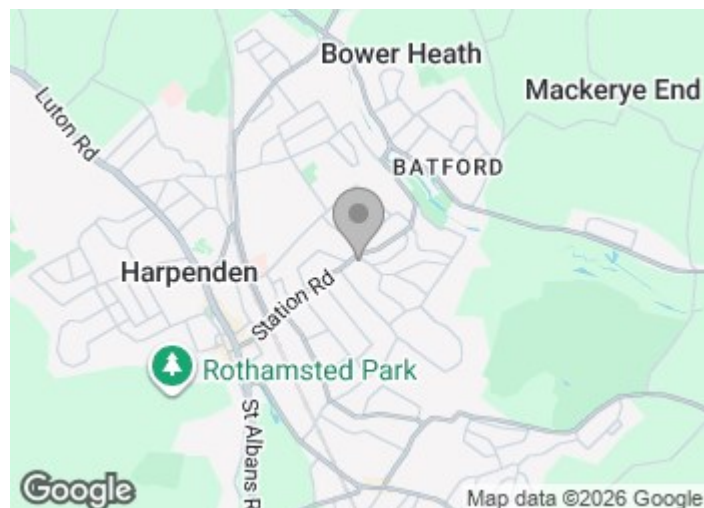

## Directions



# Floor Plan

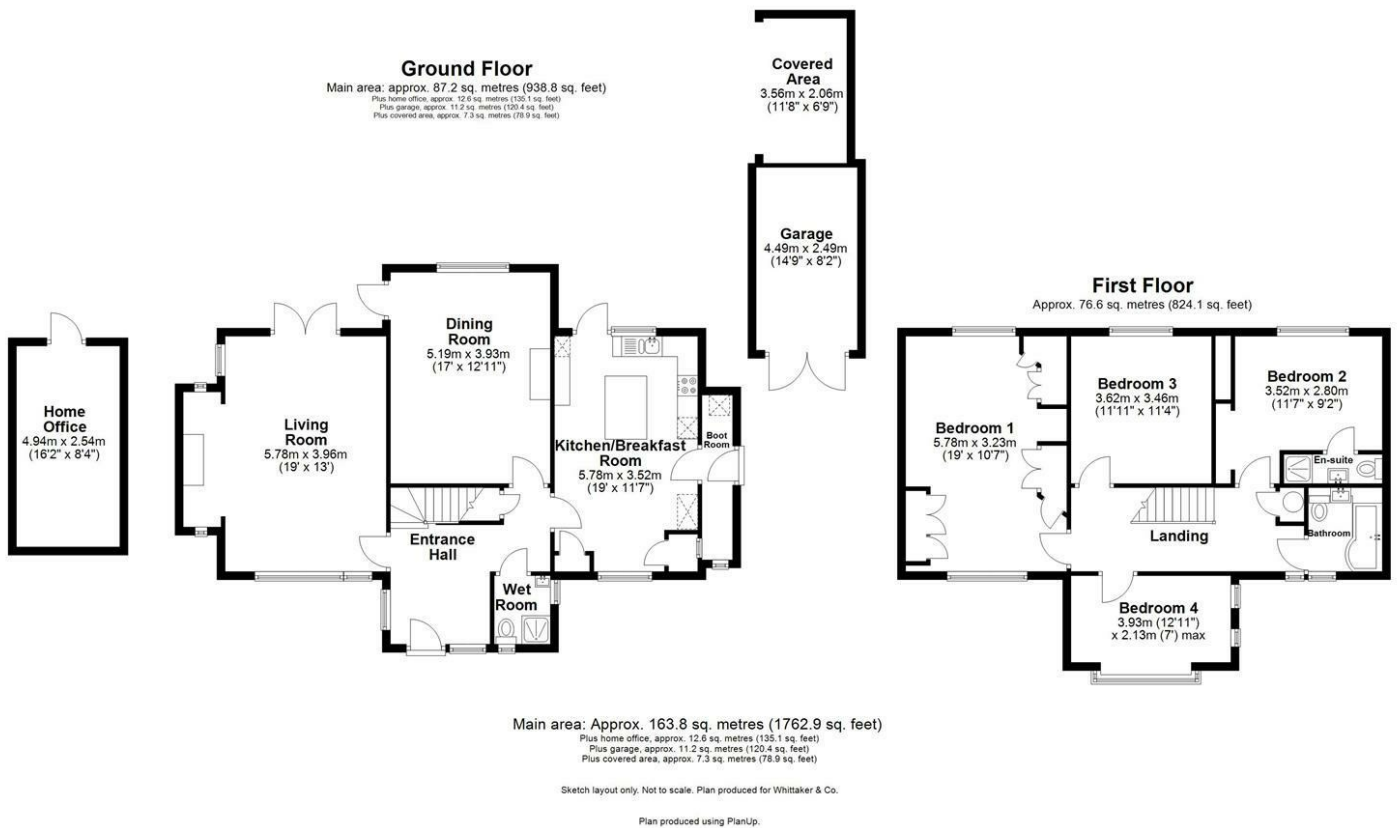

These particulars, whilst believed to be accurate are set out as a general outline only for guidance and do not constitute any part of an offer or contract. Intending purchasers should not rely on them as statements of representation of fact, but must satisfy themselves by inspection or otherwise as to their accuracy. No person in this firm's employment has the authority to make or give any representation or warranty in respect of the property.

